

Parking Management in Central City Bangna

Client: Central Pattana Public Co Ltd
 Period of Appointment: 2003

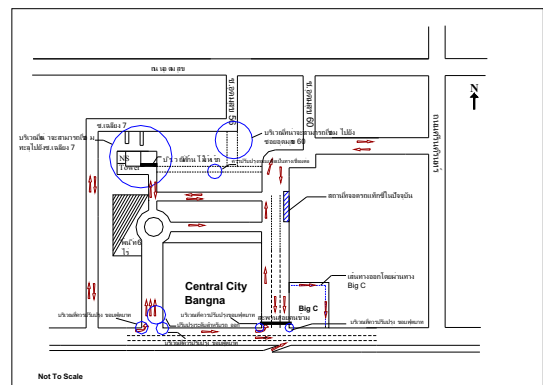

AMP Consultants Ltd has been commissioned by the Central Pattana Public Company Limited, one of the largest Retail companies in Thailand, to investigate the parking area in Central City Bangna for parking management.

In this study, AMP has suggested parking floor B1 as a transferred floor to reduce the congestion in parking area and improve traffic flow. In addition, the future plans for traffic circulation and traffic planning for the Central City Bangna are recommended.

Therefore, the key tasks are as follows:

- Traffic Circulation for Parking areas,
- Parking Management in the Central City Bangna, and
- Traffic Forecast for the future planning in terms of customer service and accessibility.

